

ATTENUATION TANK SYSTEMS

- Wide range of tank sizes to meet any project requirement
- Choice of interior partitions, e.g. with by-pass ducts/weirs, pressure release valves, both load bearing and non-load bearing
- Choice of access shafts - standard or customised - whether circular, square or rectangular to your height specification
- Inlet and outlet connections may be installed in any specified position, to the size and angle required
- Interior tank walls are 'resin-rich' to provide a durable, chemical and corrosion resistant surface with excellent flow characteristics
- Pumps to raise storm water to local mains system can be installed on pump platforms or with an integral sump. Conder also supply packaged pumping stations
- Flow regulators to ensure controlled discharge of water to meet local authority requirements
- Full technical assistance, including supporting calculations, available to ensure your system meets predicted storm water capacity and allowable discharge rates

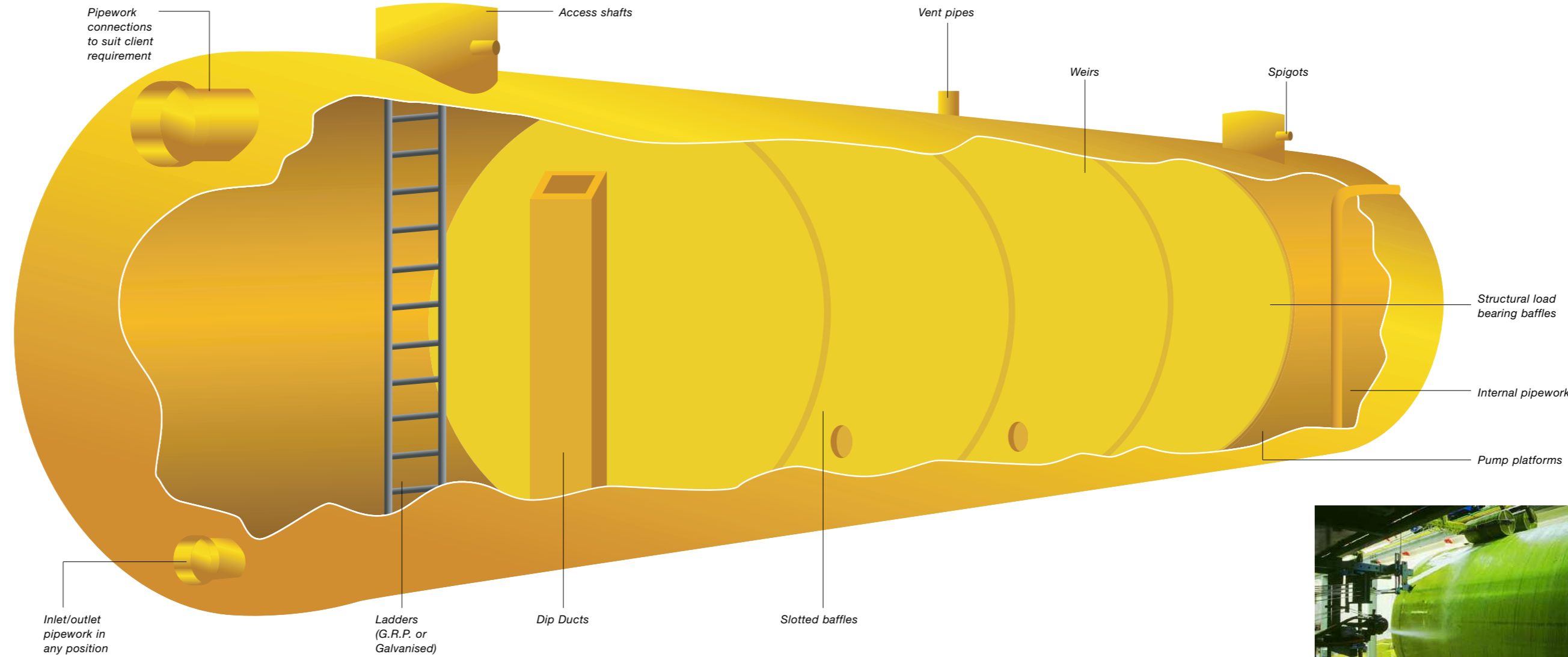

CONDER CELL

- Storm water attenuation modules for shallow installations, SUDS compliance & storage projects
- Flexible, low cost installation - easily cut on site
- Standard module dimensions: 2400mm (L), 610mm (H), 325mm (W). Custom sizes on request
- Loadings for: pedestrian, car parks and heavy duty



SPRINKLER TANKS

- Designed to meet any specification for sprinkler or fire fighting needs
- Comprehensive underground systems can be designed with load bearing structural partition dividing a dry pumping chamber, with ladder access, and an adjoining water storage tank
- Low level sumps available to maximise storage/discharge capacity
- Access requirements designed to suit the tank's specific inlet and fittings
- Complete range of ancillary items including access ladders, flanged pipework connections, ball floats, check valves and vortex inhibitors



GENERAL UNDERGROUND STORAGE TANKS

- Designed to be suitable for storing a wide range of clean or corrosive liquids. Applications include potable water, fuels, industrial effluents, domestic sewage, chemicals and other bulk liquids
- Bespoke products and customised tanks designed and manufactured to meet individual applications and customer requirements
- Tanks are usually structured in three layers from BS 5705 materials. Specific additional resins can be incorporated into each layer to ensure durable, protective tank performance and the safe, risk-free storage of corrosive or aggressive liquids and chemicals

DOUBLE WALL TANKS

- Double Wall GRP storage tanks manufactured using unique, computer-controlled patented rib design - fully compliant with PPG27 and BS EN ISO9001:2000
- Double Wall construction incorporates an interstitial space filled with a glycol/water mixture. Leak detection/alarm units available

UNDERGROUND STORAGE SIZING TABLES:

Tables are strictly for guidance only. Tanks are generally sized & manufactured to suit the application. Weights are for basic vessels, concrete surround installation, all fittings etc. need to be added.

1.0 Metre Diameter Vessels			1.2 Metre Diameter Vessels			1.5 Metre Diameter Vessels			1.8 Metre Diameter Vessels			2.5 Metre Diameter Vessels			3.0 Metre Diameter Vessels			4.0 Metre Diameter Vessels		
Capacity (litres)	Length (mm)	Weight empty (kg)	Capacity (litres)	Length (mm)	Weight empty (kg)	Capacity (litres)	Length (mm)	Weight empty (kg)	Capacity (litres)	Length (mm)	Weight empty (kg)	Capacity (litres)	Length (mm)	Weight empty (kg)	Capacity (litres)	Length (mm)	Weight empty (kg)	Capacity (litres)	Length (mm)	Weight empty (kg)
1,000	1,400	50	1,500	1,480	75	3,000	1,947	155	5,000	2,265	175	15,000	3,510	670	25,000	4,040	1,100	50,000	4,640	2,475
1,500	2,036	70	2,500	2,366	110	6,000	3,645	285	9,000	3,837	300	18,000	4,120	760	50,000	7,570	1,825	100,000	8,610	3,950
2,000	3,310	105	3,000	2,810	125	7,500	4,495	350	12,000	4,930	880	22,000	4,930	880	80,000	11,820	2,700	150,000	12,590	5,375
3,000	3,946	120	4,500	4,135	175	9,000	5,343	410	15,000	5,950	1,030	30,000	6,560	1,150	90,000	13,230	3,000	165,000	13,790	5,825
5,000	6,493	190	6,000	5,460	230	12,000	7,040	540	18,000	7,374	590	40,000	8,600	1,440	100,000	14,650	3,300	180,000	14,980	6,250
			8,000	7,230	300	15,000	8,738	670	22,000	8,946	710	50,000	10,640	1,705	200,000	16,570	6,850	220,000	18,160	7,450
									27,000	10,911	875	60,000	12,670	2,000	220,000	18,160	7,450	240,000	19,750	8,050
									30,000	12,090	975	70,000	14,710	2,300	110,000	16,060	3,600	260,000	21,340	8,625
												84,000	17,560	2,700	140,000	20,300	4,450	275,000	22,540	9,050
															150,000	21,720	4,750			

UNDERGROUND STORAGE TANKS

FEATURES AND BENEFITS

- Manufacture to BS 4994 and BS EN 976
- All vessels certified to BS EN ISO 9001 Design & Build
- Full expertise in the design of large farm or single tank stormwater balancing/attenuation systems, or sprinkler systems
- Proven high performance and specialist product storage/holding expertise
- Maintenance-free and corrosion resistant vessels
- Versatile manufacturing offers options for either granular or concrete backfill
- Lightweight construction allows easy installation
- Choice of standard tanks or custom-made systems with all access facilities, flanges, baffles, fittings and accessories, e.g. pumps and flow controllers, designed and installed to meet specific project requirements
- Full capability to manufacture grit arresting/sludge containment tanks, fire fighting reservoir tanks, oil dump tanks as well as systems which can hold solids in suspension or collect accidental chemical spillage
- Full technical, AutoCAD and product support

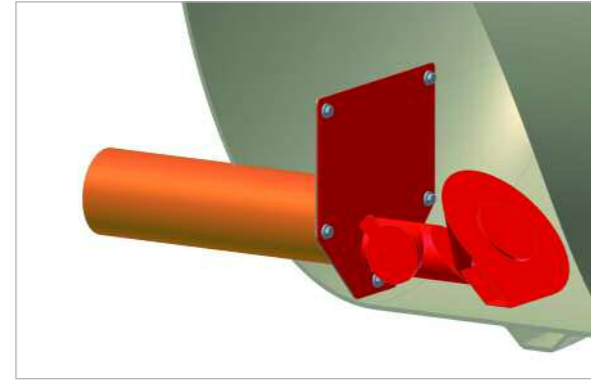
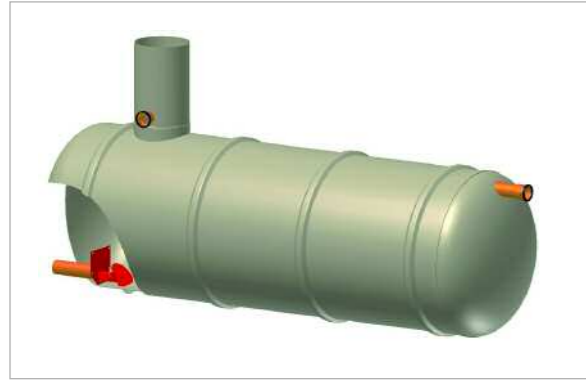

ACCESSORIES

SUBMERSIBLE PUMPS, PIPEWORK & VALVES

- The latest range of quality submersible pumps, vortex, channel or macerator products complete with internal pipework and valves - guide rail mounted or free-standing. Some sitework may be needed for deeper installations, otherwise products are generally factory fitted

ACCESS LADDERS

- Full range available to provide safe access to meet HSA and CDM regulations

FLOW REGULATORS

- Proven performance, high quality stainless steel flow regulators, complete with bypass door arrangements, for installation either integrally or downstream of the underground storage tank

BALL FLOATS, CHECK VALVES & VORTEX INHIBITORS

- Supplied with sprinkler tank systems to suit customer project requirements



ASP 6-20pe Package Sewage Treatment Plant



NSAF 25-50pe



Techflo SAF 60-600pe single-stream and multi-stream up to 1800pe



MBR Membrane Technology Package Sewage Treatment Systems (up to 5000pe)



General Underground Storage Tanks

let us make your environment a better place to be... demand special treatment



For product enquiries, specification advice, project assessments or further information, please contact the Conder team on:



t: 08702 640004 f: 08702 640005 e: sales@conderproducts.com

www.conderproducts.com
Conder Solutions Ltd, 2 Whitehouse Way,
South West Industrial Estate, Peterlee, Co Durham SR8 2RA

For nationwide service enquiries please contact:



Pims (Services) Ltd
t: 0870 405 0902 f: 01252 516404 e: sales@pimgroup.co.uk
www.pimgroup.co.uk

A member of



Conder Solutions Ltd is part of the EPS group of companies. We reserve the right to alter specification without prior notice.

TM - Techflo is a registered Trade Mark TM - Clereflo is a registered Trade Mark

storage range



the conder **attenuation, sprinkler & storage** systems

Single & Double Wall Tanks for the storage of:

- Process Water
- Potable Water
- Chemicals
- Effluent
- Sewage
- Other Bulk liquids



Attenuation & Storm Water Balancing



Class 1&2 Bypass & Full Retention oil/water separators



Package Pump Stations

Plus:

- Double Wall Tanks
- Fuel Tanks
- Cesspools & Septics
- Rainwater Harvesting Systems
- Grease/Oil Separators
- Bucket Lift Elevators
- Screenpack CSOs
- ConderCell Modular Storage
- Above Ground Engineered Vessels
- Sprinkler Tanks



demand special treatment